

EVJ-FX-N-L Nylon hammer-in fixing with countersunk head

The hammer fixing made from best quality nylon for fast, simple, cost-effective installations

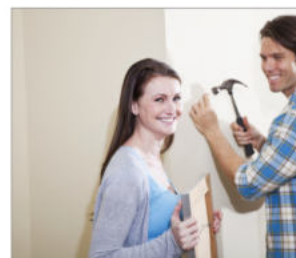

Product information

Features and benefits

- Rapid hammer-set installation reduces the time required and allows for cost-effective, high-volume installation.
- Combination of PZ recess and the helical thread makes removal of the nail possible, facilitating disassembly when necessary.
- The extensive range of product lengths and diameters with countersunk head type ensures availability of the correct fixing for every scenario
- Designed for push-through installation.

Applications

- Timber or metal battens
- Drywall structures
- Skirting / Dado railing
- Cable clamps
- Pipe clamps

Base materials

Approved for use in:

- Concrete
- Solid Brick
- Solid Sand-lime Brick
- Hollow Sand-lime Brick
- Lightweight Concrete Block
- Hollow Lightweight Concrete Block
- Aerated Concrete Block

Installation guide

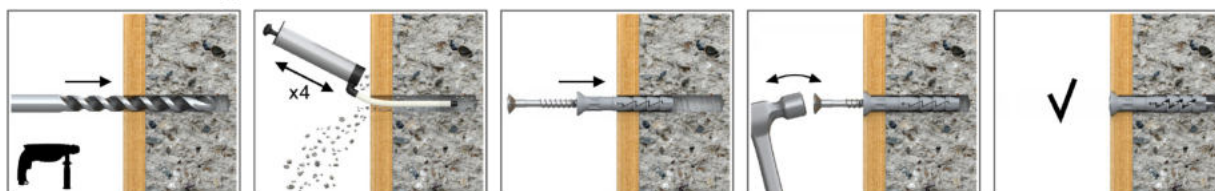

1. Drill a hole of required diameter.
2. Insert FX plug into hole through fixture.
3. Hammer the nail into the plastic sleeve until fixing is secure and flush with the fixture.

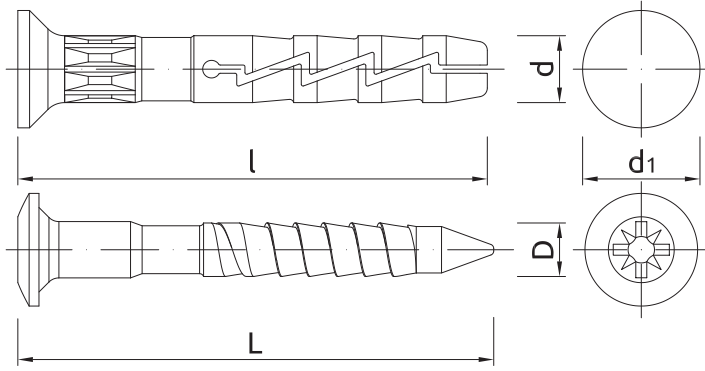

Product information

Size	Product Code	Plug		Fixture		Nail		Diameter	Quantity
		Diameter	Length	Max. Thickness	Hole diameter	Length	Diameter		
		d	l	t _{fix}	d _f	L	D	d ₁	[pcs]
Ø6	EVJ-FX-N-06L040	5.9	40	3.8	44	11	7	10	200
	EVJ-FX-N-06L080	5.9	80	3.8	84	51	7	10	100
Ø8	EVJ-FX-N-08L080	7.9	80	4.8	86	40	9	11.5	100
	EVJ-FX-N-08L100	7.9	100	4.8	86	40	9	11.5	50
	EVJ-FX-N-08L120	7.9	100	4.8	126	80	9	11.5	50

Product commercial data

Product Code	Plug	Quantity [pcs]			Weight [kg]			Bar Codes
	Diameter [mm]	Box	Outer	Pallet	Box	Outer	Pallet	
EVJ-FX-N-06L040	5.9	200	2400	57600	0.84	10.1	271.9	5906675121024
EVJ-FX-N-06L080	5.9	100	1200	28800	0.77	9.3	252.6	5906675124629
EVJ-FX-N-08L080	7.9	50	600	14400	0.68	8.2	225.8	5906675122625
EVJ-FX-N-08L100	7.9	50	600	14400	0.79	9.5	256.9	5906675123028
EVJ-FX-N-08L120	7.9	50	600	14400	0.91	10.9	292.4	5906675123424

Basic performance data

Substrate	[kN]	Concrete C12/15	Concrete C20/25 - C50/60	Solid brick	Sand-lime solid brick	Sand-lime hollow brick	Lightweight concrete hollow block	Lightweight concrete block	Solid brick min. 30MPa	Autoclaved aerated concrete
		RECOMMENDED LOAD N _{rec}								
TENSION LOAD N _{rec}										
Ø06, Effective embedment depth 29 mm	[kN]	0.07	0.11	-	0.14	0.11	0.11	0.11	0.07	0.04
Ø08, Effective embedment depth 40 mm	[kN]	0.11	0.18	-	0.14	-	0.11	0.18	0.18	0.04