

The versatile with multiple anchorage depth



Timber substructures



Wall consoles

5 Frame fixings / Stand-off installation

VERSIONS

- Zinc-plated steel
- Stainless steel

BUILDING MATERIALS

Approved for:

- Vertically perforated brick
- Aerated concrete
- Hollow blocks made from lightweight concrete
- Perforated sand-lime brick
- Thermal insulation blocks
- Solid block made from lightweight and normal weight concrete
- Solid brick
- Solid sand-lime brick
- Concrete \geq C12/15

Also suitable for:

- Natural stone with dense structure
- Solid panel made from gypsum

CERTIFICATES



ADVANTAGES

- The long expansion element with multiple anchorage depths of 50, 70 or 90 mm for SXRL 8 and SXRL 10 and 70 or 90 mm for SXRL 14 makes the SXRL a versatile applicable product.
- Through the special geometry of the plug, the loads are evenly distributed in the drill hole.
- When the plug is to be set below the plaster, the longer ribs prevent plug rotation during installation.
- The approval for single-point fixing in cracked concrete makes the SXRL the designated specialist in concrete particularly for tasks such as the installation of awning roofs and outdoor railings compared to steel anchors.
- SXRL 14 is approved for the application under compression load and is thus for example useable for facade substructures that are mounted at a distance without wall brackets.
- Complete range available with diameters of 8, 10 and 14 mm and usable lengths up to 290 mm.

APPLICATIONS

- Façade, ceiling and roof substructures made of wood and metal
- Facade substructures under compression load (e.g. distance installation without a wall bracket)
- Windows
- Gates and doors
- Wardrobes
- Kitchen hanging cabinets
- Squared timbers
- Beams
- TV consoles
- Wall covering
- Metal brackets
- Metal supports
- Cable ducts
- Cable trays

FUNCTIONING

- In hollow building materials, the two expansion zones ensure that the introduction of force is gentle on the substrate. The porous block fillets are not crushed by the second expansion zone and therefore serve to transmit the force
- In aircrete and solid building material, the two expansion zones combine to form one long expansion element, thus providing for a uniform and flat distribution of the load into substrate.
- SXRL-T with countersunk head screw is recommended for the installation of timber constructions; in the case of metal constructions, use SXRL-FUS with a wide sleeve rim and a moulded washer on the screw, which also features an integrated hexagon socket.

INSTALLATION

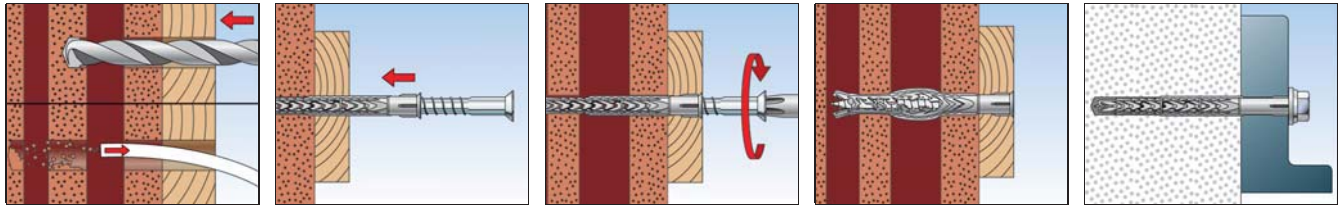

TECHNICAL DATA



SXRL-T - with fischer countersunk head safety screw

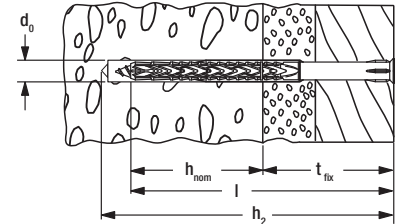

Item	Zinc-plated steel	Stainless steel	Approval		Drill diameter	Min. drill hole depth for through fixings	Usable length at anchorage depth 50mm	Usable length at anchorage depth 70mm	Usable length at anchorage depth 90mm	Anchor length	Drive	Sales unit
	Art.-No.	Art.-No.	ETA	DIBt	d_0 [mm]	h_2 [mm]	l_{fix} [mm]	l_{fix} [mm]	l_{fix} [mm]	l [mm]		[pcs]
	gvz	A4										
SXRL 8 x 60 T	540113	540119	■	—	8	70	10	—	—	60	T30	50
SXRL 8 x 80 T	540114	540121	■	—	8	90	30	10	—	80	T30	50
SXRL 8 x 100 T	540115	540123	■	—	8	110	50	30	10	100	T30	50
SXRL 8 x 120 T	540116	540124	■	—	8	130	70	50	30	120	T30	50
SXRL 8 x 140 T	540117	540125	■	—	8	150	90	70	50	140	T30	50
SXRL 8 x 160 T	540118	540126	■	—	8	170	110	90	70	160	T30	50
SXRL 10 x 60 T	546477	546505	■	●	10	70	10	—	—	60	T40	50
SXRL 10 x 80 T	522698	522709	■	●	10	90	30	10	—	80	T40	50
SXRL 10 x 100 T	522699	522710	■	●	10	110	50	30	10	100	T40	50
SXRL 10 x 120 T	522700	522711	■	●	10	130	70	50	30	120	T40	50
SXRL 10 x 140 T	522701	522712	■	●	10	150	90	70	50	140	T40	50
SXRL 10 x 160 T	522703	522713	■	●	10	170	110	90	70	160	T40	50
SXRL 10 x 180 T	522704	522714	■	●	10	190	130	110	90	180	T40	50
SXRL 10 x 200 T	522705	522715	■	●	10	210	150	130	110	200	T40	50
SXRL 10 x 230 T	522706	522716	■	●	10	240	180	160	140	230	T40	50
SXRL 10 x 260 T	522707 ¹⁾	522717 ¹⁾	■	●	10	270	210	190	170	260	T40	50
SXRL 10 x 290 T	522708 ¹⁾	522718 ¹⁾	■	●	10	300	240	220	200	290	T40	50
SXRL 14 x 80 T	530920	530932	■	●	14	95	—	10	—	80	T50	50
SXRL 14 x 100 T	530921	530933	■	●	14	115	—	30	10	100	T50	50
SXRL 14 x 120 T	530922	530934	■	●	14	135	—	50	30	120	T50	50
SXRL 14 x 140 T	530923	530935	■	●	14	155	—	70	50	140	T50	50
SXRL 14 x 160 T	530924	530936	■	●	14	175	—	90	70	160	T50	50
SXRL 14 x 180 T	530925	530937	■	●	14	195	—	110	90	180	T50	50
SXRL 14 x 200 T	530926	530938	■	●	14	215	—	130	110	200	T50	50
SXRL 14 x 230 T	530927	530939	■	●	14	245	—	160	140	230	T50	50
SXRL 14 x 260 T	530928	530940	■	●	14	275	—	190	170	260	T50	50
SXRL 14 x 300 T	530929 ¹⁾	530941 ¹⁾	■	●	14	315	—	230	210	300	T50	20
SXRL 14 x 330 T	530930 ¹⁾	530942 ¹⁾	■	●	14	345	—	260	240	330	T50	20
SXRL 14 x 360 T	530931 ¹⁾	530943 ¹⁾	■	●	14	375	—	290	270	360	T50	20

1) not pre-assembled

TECHNICAL DATA



SXRL-FUS - with fischer hexagon head safety screw, moulded washer and integrated bit recess

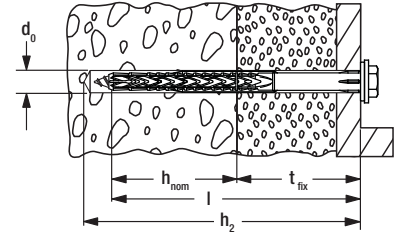

5 Frame fixings / Stand-off installation

Item	Zinc-plated steel	Stainless steel	Approval		Drill diameter	Min. drill hole depth for through fixings	Usable length at anchorage depth 50mm	Usable length at anchorage depth 70mm	Usable length at anchorage depth 90mm	Anchor length	Drive	Sales unit
	Art.-No.	Art.-No.	ETA	DIBt	d_0 [mm]	h_2 [mm]	t_{fix} [mm]	t_{fix} [mm]	t_{fix} [mm]	l [mm]		[pcs]
	gvs	A4										
SXRL 8 x 60 FUS	540127	540135	■	—	8	70	10	—	—	60	T30/SW10	50
SXRL 8 x 80 FUS	540129	540136	■	—	8	90	30	10	—	80	T30/SW10	50
SXRL 8 x 100 FUS	540130	540137	■	—	8	110	50	30	10	100	T30/SW10	50
SXRL 8 x 120 FUS	540131	—	■	—	8	130	70	50	30	120	T30/SW10	50
SXRL 8 x 140 FUS	540133	—	■	—	8	150	90	70	50	140	T30/SW10	50
SXRL 8 x 160 FUS	540134	—	■	—	8	170	110	90	70	160	T30/SW10	50
SXRL 10 x 60 FUS	546506	546507	■	●	10	70	10	—	—	60	T40/SW13	50
SXRL 10 x 80 FUS	522719	522730	■	●	10	90	30	10	—	80	T40/SW13	50
SXRL 10 x 100 FUS	522720	522731	■	●	10	110	50	30	10	100	T40/SW13	50
SXRL 10 x 120 FUS	522721	522732	■	●	10	130	70	50	30	120	T40/SW13	50
SXRL 10 x 140 FUS	522723	522733	■	●	10	150	90	70	50	140	T40/SW13	50
SXRL 10 x 160 FUS	522724	522734	■	●	10	170	110	90	70	160	T40/SW13	50
SXRL 10 x 180 FUS	522725	522735	■	●	10	190	130	110	90	180	T40/SW13	50
SXRL 10 x 200 FUS	522726	522736	■	●	10	210	150	130	110	200	T40/SW13	50
SXRL 10 x 230 FUS	522727	522737	■	●	10	240	180	160	140	230	T40/SW13	50
SXRL 10 x 260 FUS	522728 1)	522738 1)	■	●	10	270	210	190	170	260	T40/SW13	50
SXRL 10 x 290 FUS	522729 1)	522739 1)	■	●	10	300	240	220	200	290	T40/SW13	50
SXRL 14 x 80 FUS	530946	530955	■	●	14	95	—	10	—	80	T50/SW17	50
SXRL 14 x 100 FUS	530947	530956	■	●	14	115	—	30	10	100	T50/SW17	50
SXRL 14 x 120 FUS	530948	530957	■	●	14	135	—	50	30	120	T50/SW17	50
SXRL 14 x 140 FUS	530949	530958	■	●	14	155	—	70	50	140	T50/SW17	50
SXRL 14 x 160 FUS	530950	530959	■	●	14	175	—	90	70	160	T50/SW17	50
SXRL 14 x 180 FUS	530951	530960	■	●	14	195	—	110	90	180	T50/SW17	50
SXRL 14 x 200 FUS	530952	530961	■	●	14	215	—	130	110	200	T50/SW17	50
SXRL 14 x 230 FUS	530953	530962	■	●	14	245	—	160	140	230	T50/SW17	50
SXRL 14 x 260 FUS	530954	530963	■	●	14	275	—	190	170	260	T50/SW17	50

1) not pre-assembled

ACCESSORIES



SXRL - without screw

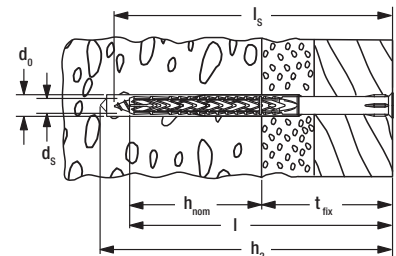

Item	Art.-No.	Drill diameter	Min. drill hole depth for through fixings	Usable length at anchorage depth 50mm	Usable length at anchorage depth 70mm	Usable length at anchorage depth 90mm	Anchor length	Screw diameter	Min. screw length	Sales unit
		d_0 [mm]	h_2 [mm]	t_{fix} [mm]	t_{fix} [mm]	t_{fix} [mm]	l [mm]	d_s [mm]	l_s [mm]	[pcs]
SXRL 8 x 60	540879	8	70	10	—	—	60	5,5 - 6,0	65	100
SXRL 8 x 80	540880	8	90	30	10	—	80	5,5 - 6,0	85	100
SXRL 8 x 100	540881	8	110	50	30	10	100	5,5 - 6,0	105	100
SXRL 8 x 120	540882	8	130	70	50	30	120	5,5 - 6,0	125	100

ACCESSORIES



Cover cap ADT

Item	Art.-No.	Colour	Cap [Ø mm]	Match	Sales unit [pcs]
ADT 15 W	060326	white	15	Safety screw with integrated bit recess T40	100
ADT 15 DB	060329	dark brown	15	Safety screw with integrated bit recess T40	100
ADT 18 W	060334	white	18	Safety screw with integrated bit recess T40	100
ADT 18 DB	060337	dark brown	18	Safety screw with integrated bit recess T40	100

ACCESSORIES



Washer U

Item	Art.-No.	External-Ø d [mm]	Hole-Ø D [mm]	Thickness S [mm]	Matching anchor type	Sales unit [pcs]
U 11,5 x 21 x 1,5 DIN 522 A2	010026	21	11.5	1.5	SXR 10, SXRL 10, FUR 10	500

LOADS

Frame fixing SXRL³⁾

Highest recommended loads¹⁾ for a single anchor as part of a multiple fixing of non-structural systems.
The given loads are valid for wood screws with the specified diameter.

Type	SXRL 8				
Anchorage depth	h_{nom}	[mm]	50	70	90
Screw diameter	Ø	[mm]	6,0	6,0	6,0
Min. edge distance concrete	a_r	[mm]	60	80	100
Recommended loads in the respective base material F_{rec}²⁾					
Concrete	$\geq C20/25$	[kN]	0,60	1,00	1,00
Solid brick	$\geq Mz 12$	[kN]	0,45	0,60	0,60
Solid sand-lime brick	$\geq KS 12$	[kN]	0,40	0,50	0,50
Vertically perforated brick	$\geq Hlz 12 (\rho \geq 1,0 \text{ kg/dm}^3)$	[kN]	0,15	0,15	0,15
Perforated sand-lime brick	$\geq KSL 12$	[kN]	0,10	0,40	0,40
Aerated concrete	AAC 2	[kN]	-	0,10	0,10
Aerated concrete	AAC 4	[kN]	-	0,15	0,20

¹⁾ Required safety factors are considered.

²⁾ Valid for tensile load, shear load and oblique load under any angle.

³⁾ Valid for zinc coated screws and for screws made of stainless steel. For exterior use of the zinc coated screws measures against incoming humidity have to be taken.