

# Cast-in Device FCiD Plus





# Cast-in Device FCiD Plus

Fast and efficient solution for forming service penetrations through concrete floors

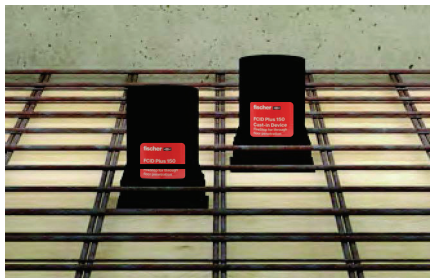

FCiD Plus within reinforced concrete floor



Installed pipe through FCiD Plus

## Applications

- Sealing and firestopping combustible and metal pipes up to 168 mm.
- Forms holes up to 200mm thick concrete floors.
- Can be used in thicker floor slabs by adding necessary number of 100mm extension tubes.
- Extensions can easily be cut and finished by removable lid for precise adjustment.
- Sealing and firestopping insulated pipes, cable bundles and multiple pipes.
- FCiD Plus can be trimmed and used in thinner concrete slabs, starting only from 64m
- Fire rating applicable even without any through penetrants if placed wrong or penetrant's location is changed.

## Advantages

- Quick installation
- Easy to use & reusable locator plate
- Watertight seal
- Higher tolerance
- Easily extendable
- Removable lid with identification label
- No further collars or wraps required
- Reduce working at heights
- Cost saving
- Reduced foot plate
- Closer proximity positioning
- Free of asbestos, solvents and any hazardous ingredients.

## Function

- FCiD Plus is a pass through system, which is constructed from a highly resilient polypropylene material and contains a powerful intumescent graphite band.
- The FCiD Plus is rugged enough to withstand the force and load of a concrete pour, yet lightweight enough to permit easy placement and handling.

## Building Materials

- Reinforced cast concrete slabs
- Some prefabricated slab systems (subject to design).
- Metal decking concrete composite slabs

## Certificates

**EN 1366-3 : 2021**

Fire resistance tests for service installations penetration seals.

**ASTM E 814 (UL 1479).**

**BS 476-20**



## Resistance table

Penetrant	FCiD Plus size	Diameter of penetrant (mm)	Max Fire Resistance (min.)	
			Integrity	Insulation
Blank	-	-	180	180
PVC-U	150	160	240	240
PVC-U	100	110	240	240
PVC-U	75	75	120	120
PVC-U	75	63	120	120
PVC-U	50	50	180	180
Metal pipe	50, 75, 100, 150	50, 75, 100, 150, Steel Schedule 5, Copper Type L and Regular	180	180
PVC, PVC-XFR, (RNC)+	50, 75, 100	60, 90, 114	180	180
PVC, PVC-XFR, (RNC)+	150	168	180	165
CPVC	50	60	180	180
CPVC	75	90	180	135
CPVC	100	114	180	135
CPVC	100	114	180	165
PEX tubing	50	54	180	-
PP-R	50	63	180	180
PP-R	75	90	180	-
PP-R	100	125	180	-
Cable bundle	50, 75, 100, 150	25 to 152	180	45
Insulated Metal pipe	50, 75, 100	Max. 150 (Max. 25 insulation)	180	120
Multiple pipes (cc PVC, PVC, PEX & metal)	50, 75, 100, 150	Max. 3 no of 38mm	120	60

**Important Note:** Please refer to product test and assessment reports for accurate assembly details and fire ratings.

# Cast-in Device FCiD Plus

## Technical data

Item	Item No.	VJ Item No.	Fits pipe-Ø	Height H	Sales unit
		[mm]	[mm]	[mm]	[pcs]
FCiD Plus 50	566285	30001500	50 - 63	200	12
FCiD Plus 75	566286	30001510	63 - 90	200	12
FCiD Plus 100	566287	30001520	100 - 125	200	12
FCiD Plus 150	566288	30001530	150 - 168	200	6
FCiD Plus 50 extension	566289	30001540	50 - 63	100	6
FCiD Plus 75 extension	566290	30001550	63 - 90	100	6
FCiD Plus 100 extension	566291	30001560	100 - 125	100	6
FCiD Plus 150 extension	566292	30001570	150 - 168	100	6
FCiD Plus 50 deck adapter	566293	On request	-	-	1
FCiD Plus 75 deck adapter	566294	On request	-	-	1
FCiD Plus 100 deck adapter	566295	On request	-	-	1
FCiD Plus 150 deck adapter	566296	On request	-	-	1
FCiD Plus 75 Locator Plate	-	30001660	-	-	1
FCiD Plus 100 Locator Plate	-	30001670	-	-	1
FCiD Plus 150 Locator Plate	-	30001680	-	-	1
FCiD Plus 50 extension 50	-	30001580	-	50	1
FCiD Plus 75 extension 50	-	30001590	-	50	1
FCiD Plus 100 extension 50	-	30001600	-	50	1
FCiD Plus 150 extension 50	-	30001610	-	50	1
FCiD Plus 50 extension 25	-	30001620	-	25	1
FCiD Plus 75 extension 25	-	30001630	-	25	1
FCiD Plus 100 extension 25	-	30001640	-	25	1
FCiD Plus 150 extension 25	-	30001650	-	25	1

Device and extension tube can be cut to suit concrete slab. This cutting service is provided by VJT on request.

## Technical data

State	solid
Odour	odourless
Fire resistance	Up to 4 hours - EN 1366-3 & BS476-20 & UL 1479
Extension or reduction in height possible	Yes
Standard flange width	min 154 mm and max 254 mm
Significant expansion occurs at temperature	> 190 °C
Shelf life	n/a
Colour	black

# Installation Instructions

Figure 1.

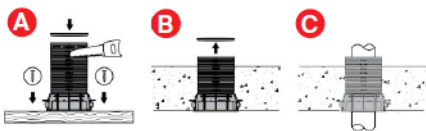

### FCiD Plus Cast-In-Device Installation.

1. Select FCiD to fit the diameter of penetrant being used, assuring annular space is within limits set by the tested conditions. Layout the FCiD on concrete forms or metal deck, and secure by nailing or screwing through fastening holes on the bottom of the flange. FCiD alignment connectors allow tight placement of multiple penetrations. If finished concrete is lower than the height of the FCiD, cut to finished pour height. Use appropriate non-heat generating cutting tool to cut the FCiD to the desired height. Fig.1 (A).
2. Before pouring concrete, ensure top cap of the FCiD is secure to prevent the flow of concrete into the FCiD during the concrete pour. Fig.1 (A).
3. Once the concrete is cured, remove the FCiD cap to use FCiD. Fig.1 (B).
4. The FCiD is ready to use, insert the desired penetrant through. Fig.1 (C).

Figure 2.

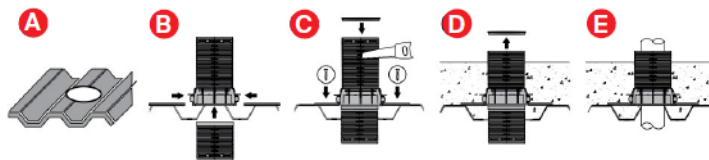

### FCiD Plus Cast-In Device Metal Adapter Installation.

1. For metal decking applications, cut hole in the corrugated metal deck to FCiD size to be used. Fig. 2 (A).
2. Use metal deck adapter kit to install FCiD by attaching deck support to bottom flange then insert extension tube into the bottom of FCiD. Fig. 2 (B).
3. Insert extension tube through the precut hole in decking & fasten decking supports to deck with screws. Ensure extension is sealed to prevent leakage of concrete through decking. Fig. 2 (C). If finished concrete is lower than the height of FCiD, cut to finished pour height. Use appropriate non-heat generating cutting tool to cut FCiD to the desired height. Before pouring concrete, ensure top cap of FCiD is secure to prevent the flow of concrete into the FCiD during the pour. Fig. 2 (C).
4. Once the concrete is cured, remove the FCiD cap to use FCiD. Fig. 2 (D).
5. FCiD is ready to use, insert the desired penetrant through. Fig. 2 (E).

Figure 3.

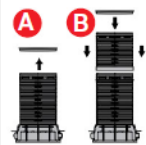

### FCiD Plus Cast-In Device Height Extension Installation

1. Remove FCiD cap from the device. Insert appropriate size FCiD extension(s) onto FCiD aligning connector tabs from FCiD with extension receiving slots. Fig.3 (A).
2. Attach additional extensions to reach desired height & place FCiD cap back on before pouring concrete. Fig. 3 (B).

#### Locator Plate Installation (Optional)

1. Place the matching size locator plate to the exact location by aligning the centre hole to the centre of the marked pipe location on concrete shuttering.
2. Fix the locator plate to the shuttering by using nails or screws through the holes.
3. Fit the FCiD Plus Cast-in Device on the locator plate and follow regular instruction steps (Figure 1).

Important note: Please do NOT use the device if rubber strip or intumescent strip is damaged and contact fischer technical support services: [technical-uk@fischer.co.uk](mailto:technical-uk@fischer.co.uk)

**fischer FCiD Plus**  
**Exclusive Distributor**

**VJT Head Office**

**Phone:**

Sales: 01233 652 550

Technical: 01233 652 520

**Email:**

ashford@vjtechnology.com

Datasheet and Product Information Requests:

technical@vjtechnology.com

**Opening Hours:**

Mon-Fri 8am-5pm

**Address**

Technology House,  
Brunswick Road,  
Ashford, Kent,  
TN23 1EN

**VJT Trade Counter**

Ashford Opening Hours:

Mon-Fri 7am-5pm

Sat 8am-12 noon



[www.fischer.co.uk](http://www.fischer.co.uk)



fischer fixings UK Ltd.

Whitely Road, Wallingford, Oxon, OX109AT.

Tel. 01491 827900 · Fax 01491 827953

[sales@fischer.co.uk](mailto:sales@fischer.co.uk) · [technical-uk@fischer.co.uk](mailto:technical-uk@fischer.co.uk) · [www.fischer.co.uk](http://www.fischer.co.uk)