

# GRIPPS®

ANSI/ISEA  
121-2023  
COMPLIANT

## H01141 MULE TOOL BACKPACK

*The GRIPPS® Mule Tool Backpack is ideally suited to tool technicians working at heights and is ANSI/ISEA 121-2023 compliant. This certification enhances its standing as a reliable and robust tool backpack, surpassing standard tool backpacks.*

A notable feature is the load-rated mounting straps, specifically designed for teams working near or on rail or scaffolding. These straps allow workers to secure the backpack off the ground, enhancing convenience and accessibility. The 20kg (44lb) load rating adds to its versatility, ensuring that it can accommodate a substantial amount of tools and equipment.

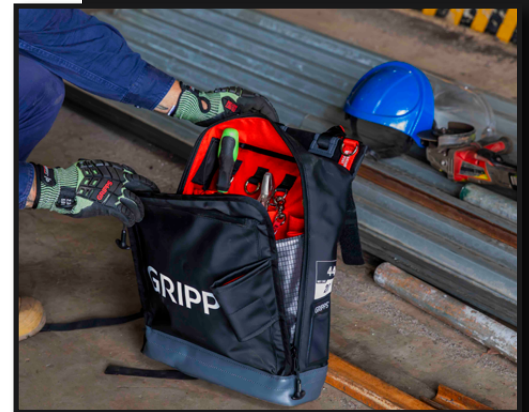

ENGINEERED FOR DROP PREVENTION

[gripps.com](http://gripps.com)

## KEY FEATURES

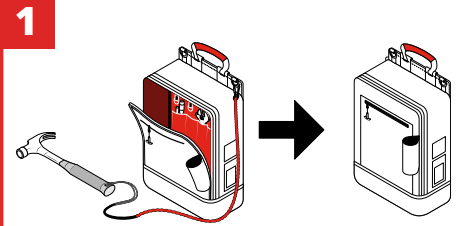

1 When transporting contents at height, ensure all zips are sealed.

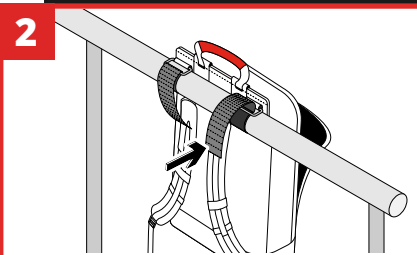

2 To secure to a rail, wrap the straps all the way around the rail and feed back through the metal bracket.

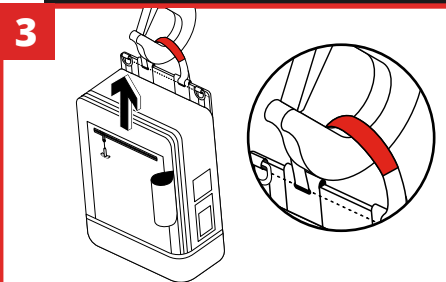

3 Ensure all tools are tethered to D-Rings and zips fully sealed. Attach lifting hook to the red upper lifting strap.

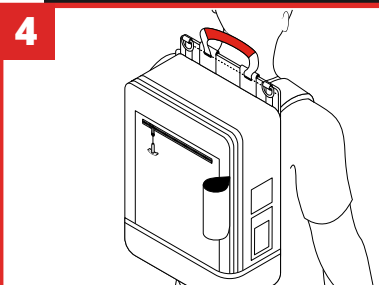

4 To manually transport, put arms through shoulder straps, and adjust length as required. Refer to your workplace guidance on safe manual handling guidelines.

## SPECIFICATIONS

SKU	MAX LOAD (D-RING)	MAX LOAD (LIFFTING)	MAX TETHER LENGTH
H01141	2.5 kg   5.5 lb	20 kg   4.4 lb	1.3 m   51 in
LENGTH	WIDTH	HEIGHT	MAX TETHER WEIGHT
33 cm   12.99 in	20 cm   7.87 in	40 cm   15.75 in	3 kg   6.6 lb

\*Dimensions reflect the bag body; the flexible opening adds extra room (14 cm | 5.51 in).

**ANSI/ISEA 121-2023 - Compliant**  
**AS4991-2004 - Compliant**  
**BS EN 1492-1+A1:2008 - Compliant**

\*Last update: 14.01.26

@GRIPPSGLOBAL



#ConquerGravity