

**Type CF**

SG iron, hot dip galvanised

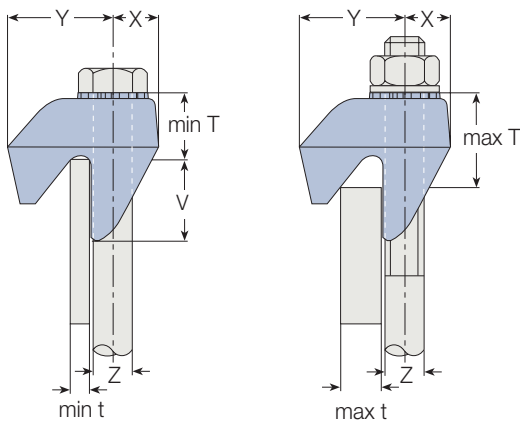
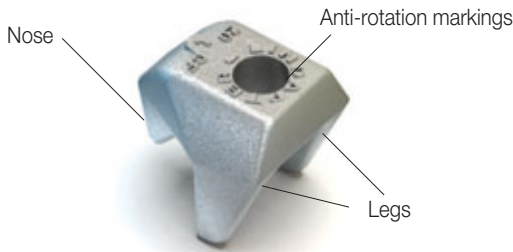

High friction clamp which hooks over flanges of I-beams, angles and channels. Lindapter markings act as a unique anti-rotation device. Can be combined with all Lindapter Girder Clamp products including type AF.

**Typical Applications**  
(see also page 36-39)

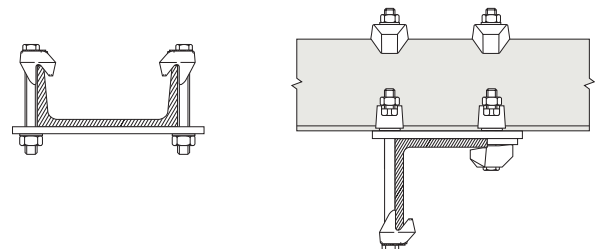

Product Code	Bolt 8.8 Z	Safe Working Loads				Torque Nm	Dimensions				
		Tensile / 1 Bolt (5:1)	factor of safety (2:1)		Frictional <sup>1)</sup> / 2 Bolts		Y mm	X mm	t mm	T mm	V mm
		kN	Painted Steelwork <sup>2)</sup>	Galv. Steelwork	kN						
CF12	M12	8.5	3.4	3.9	90	32	14	6 - 13	21 - 29	25	46
CF16	M16	16.0	8.0	10.0	240	44	18	8 - 16	25 - 33	32	56
CF20	M20	26.3	13.0	16.0	470	53	22	10 - 19	30 - 41	45	65

CF Combinations with other Lindapter Clamps					
		kN	kN	kN	Nm
CF / A <sup>3)</sup>	M12	5.8	0.7	0.7	69
CF / A <sup>3)</sup>	M16	7.3	1.5	1.7	147
CF / A <sup>3)</sup>	M20	14.7	3	3.0	285
CF / AF	M12	8.5	3.4	3.9	90
CF / AF	M16	16.0	8.0	10.0	240
CF / AF	M20	26.3	13.0	16.0	470

■ Order example: CF12

1) Frictional load figures are based on type CF and location plate in HDG finish  
 2) Shot blast and painted steelwork  
 3) Also applies to type B, BR, LR, D2 or D3