

R-OLD Plastic expansion plug

All purpose cost effective fixing made of impact-resistant polypropylene for medium and lightweight applications

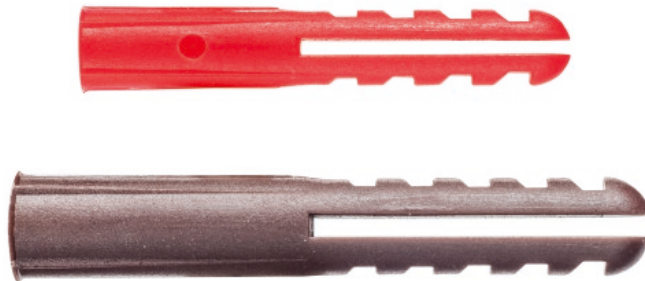

Product information

Features and benefits

- Profiled body for extra grip.
- Anti-rotation fins prevent spinning during tightening of the screw.
- Tree colour coded sizes for screws from 3-6mm diameter.
- Additional sizes for screws 3-10mm.
- Plug made of impact resistant co-polymer of polypropylene.

Applications

- Pictures
- Lighting
- Skirting / Dado railing
- Shelves
- Trunking
- Cable trays
- Electrical fittings

Base materials

Suitable for use in

- Concrete
- Solid Brick

Installation guide

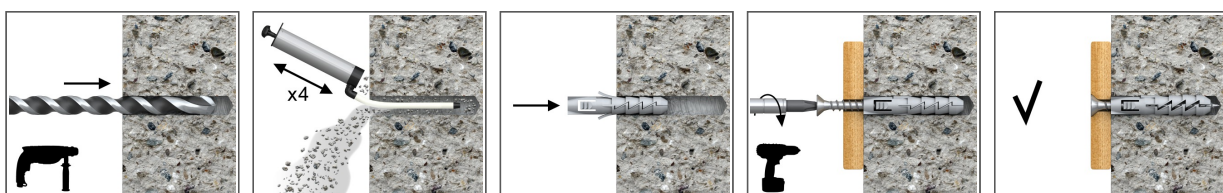

1. Drill a hole of required diameter.
2. Insert FIX plug into the hole and tap home.
3. Insert screw of required diameter into plug through fixture and tighten.

Product information

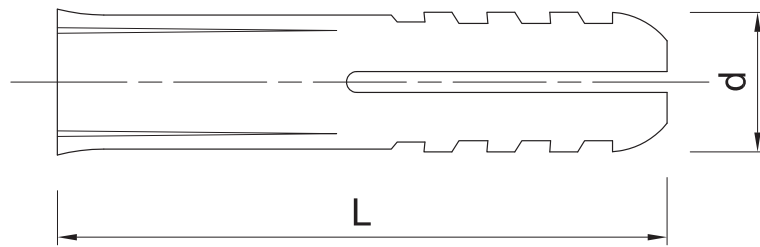

Product Code	Description	Screw dimensions	Plug	Hole diameter
			Length	
			l	d
[mm]				
R-OLD-YEL-20-NC	YELLOW	3.0-5.0	25	5
R-OLD-YEL-100-NC	YELLOW	3.0-5.0	25	5
R-OLD-YEL-100-C	YELLOW	3.0-5.0	25	5
R-OLD-YEL-300	YELLOW	3.0-5.0	25	5
R-OLD-YEL-1000	YELLOW	3.0-5.0	25	5
R-OLD-RED-20-NC	RED	3.5-5.5	35	6
R-OLD-RED-100-NC	RED	3.5-5.5	35	6
R-OLD-RED-100-C	RED	3.5-5.5	35	6
R-OLD-RED-300	RED	3.5-5.5	35	6
R-OLD-RED-1000	RED	3.5-5.5	35	6
R-OLD-BRN-20-NC	BROWN	5.0-6.0	45	7
R-OLD-BRN-100-NC	BROWN	5.0-6.0	45	7
R-OLD-BRN-100-C	BROWN	5.0-6.0	45	7
R-OLD-BRN-1000	BROWN	5.0-6.0	45	7
R-OLD-BRN-300	BROWN	5.0-6.0	45	7
R-OLD-MIX-300	ASSORTED yellow, red, brown	3.0-6.0	25.45	5.7

Product commercial data

Product Code	Description	Screw dimensions [mm]	Hole diameter [mm]	Quantity [pcs]			Weight [kg]			Bar Codes
				Box	Outer	Pallet	Box	Outer	Pallet	
R-OLD-YEL-20-NC	YELLOW	3.0-5.0	5	1	1	168	0.45	0.45	105.6	
R-OLD-YEL-100-NC	YELLOW	3.0-5.0	5	1	1	345	0.35	0.35	150.8	
R-OLD-YEL-100-C	YELLOW	3.0-5.0	5	1	1	280	0.39	0.39	139.5	5010445671272
R-OLD-YEL-300	YELLOW	3.0-5.0	5	1	1	40	2.0	2.0	110.0	5010445679001
R-OLD-YEL-1000	YELLOW	3.0-5.0	5	1	50	320	5.4	270.0	1758.0	
R-OLD-RED-20-NC	RED	3.5-5.5	6	1	1	112	0.66	0.66	103.4	5010445671388
R-OLD-RED-100-NC	RED	3.5-5.5	6	1	1	168	0.64	0.64	137.5	
R-OLD-RED-100-C	RED	3.5-5.5	6	1	1	168	0.79	0.79	162.6	5010445671364
R-OLD-RED-300	RED	3.5-5.5	6	1	1	44	4.0	4.0	207.7	5010445679025
R-OLD-RED-1000	RED	3.5-5.5	6	1	24	288	0.55	13.3	189.3	
R-OLD-BRN-20-NC	BROWN	5.0-6.0	7	1	1	96	1.04	1.04	129.8	5010445672378
R-OLD-BRN-100-NC	BROWN	5.0-6.0	7	1	1	56	1.02	1.02	87.2	
R-OLD-BRN-100-C	BROWN	5.0-6.0	7	1	1	56	1.05	1.05	89.0	5010445672330
R-OLD-BRN-1000	BROWN	5.0-6.0	7	1	15	180	0.55	8.3	129.5	
R-OLD-BRN-300	BROWN	5.0-6.0	7	1	1	21	6.2	6.2	160.2	5010445679049
R-OLD-MIX-300	ASSORTED yellow, red, brown	3.0-6.0	5.7	1	1	24	4.0	4.0	124.8	5010445679056