

EJOT Super-SAPHIR® Self-Drilling JT3-FR2 Timber Range

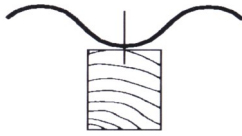

Material Specification

Fastener.

High quality Stainless steel
grade 304 St/St, ISO group
A2, Din Werkstoff 1.4301.

Drill Point

High quality grade casehardened carbon steel to Din standard
10666.

Drive System

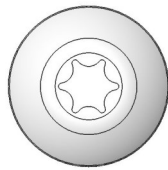

TORX®
T25
Recess

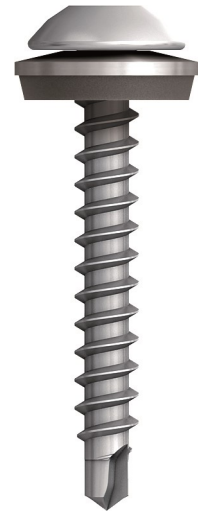

Ultimate Fastener Shear Strength

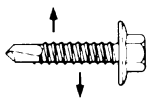

| Fastener Dia | kN |
|--------------|------|
| 4.9 x L | 5.10 |

Ultimate Fastener Tensile Strength



| Fastener Dia | kN |
|--------------|------|
| 4.9 x L | 8.05 |

Ultimate Pullout Load kN

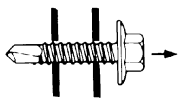

| Fastener Dia | Timber | |
|--------------|----------------|----------------|
| | 30mm Embedment | 25mm Embedment |
| 4.9 x L | 2.830 | 2.011 |

Figures based on tests from timber designated GS Graded (SC3) to BS 5268 Pt. 2 1984

Figures above are based on results obtained from tests carried out in our Applitec lab in accordance with equipment conforming to BS 5427 on a random sample of fasteners manufactured to EJOT tolerances. Information supplied should form part of a general guide and should performance data for a specific application be required please do not hesitate to contact us.

EJOT UK Limited Sherburn-in-Elmet, Leeds LS25 6PB.

Tel: 01977 687040 Fax: 01977 687041

www.ejot.co.uk info@ejot.co.uk