

IH103 / IH142 Saddle Guide

for steel, copper and insulated pipes 15 - 176 mm

(P 04 25)

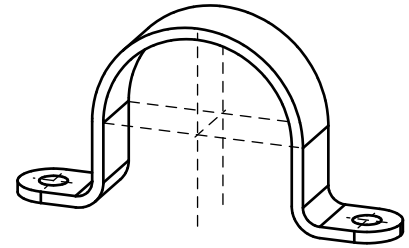

Features and benefits

- Type IH103: zinc plated, for steel pipe
- Type IH142: nylon coated, for copper pipe
- with clearance to allow movement
- also available in:
 - self colour
 - hot dip galvanized

Part No.	D (mm)	D (°)	DN	Type	B (mm)	H (mm)	b x s (mm)	d1 (mm)	k (mm)	Pack 1
B3203024	24	1/2	15	IH103	92	26	25 x 3.0	7	66	50
B3203030	30	3/4	20	IH103	103	32	25 x 3.0	7	77	50
B3203037	37	1	25	IH103	106	39	25 x 3.0	7	80	50
B3203046	46	1 1/4	32	IH103	132	47	30 x 3.0	11	100	50
B3203054	54	1 1/2	40	IH103	142	55	30 x 3.0	11	110	50
B3203064	64	2	50	IH103	152	65	30 x 3.0	11	120	25
B3203082	82	2 1/2	65	IH103	188	81	40 x 3.0	14	148	25
B3203095	95	3	80	IH103	200	95	40 x 3.0	14	160	25
B3203120	120	4	100	IH103	230	120	40 x 3.0	14	190	25
B3203176	176	6	150	IH103	290	178	40 x 5.0	14	250	25
B3206017	15	-	-	IH142	86	19	25 x 3.0	7	60	50
B3206030	28	-	-	IH142	101	32	25 x 3.0	7	75	50
B3206038	35	-	-	IH142	109	40	25 x 3.0	7	83	50

PP-strip is used to isolate copper pipe from any supporting steel structure. Please refer to page Q 05 85. Please specify if required.

