

Hammerset anchor EA-N

The cost-efficient hammerset anchor for an easy installation



Height adjustable pipe installation



Pipelines

4

Applications

- Pipeline routes
- Cable trays
- Consoles

Advantages

- The hammerset anchor with internal thread is suitable for pre-positioned installation.
- The EA-N fits for all standard screws with

metric/inch – thread.

- The available internal thread diameter from 6 mm to 20 mm provides flexibility in the application.

Building materials

- Concrete C12/15 to C50/60, non-cracked

Versions

- Zinc-plated steel

Functioning

- Put the hammerset anchor in the drill hole and get it flush to the surface by hammering in.
- With the hammerset tool EA-ST the capsule will spread due to hammering in the internal bolt and tensed up against the drill hole wall.
- The hammerset tools must be set up on the edge of the anchor for a correct expansion.

Installation EA-N

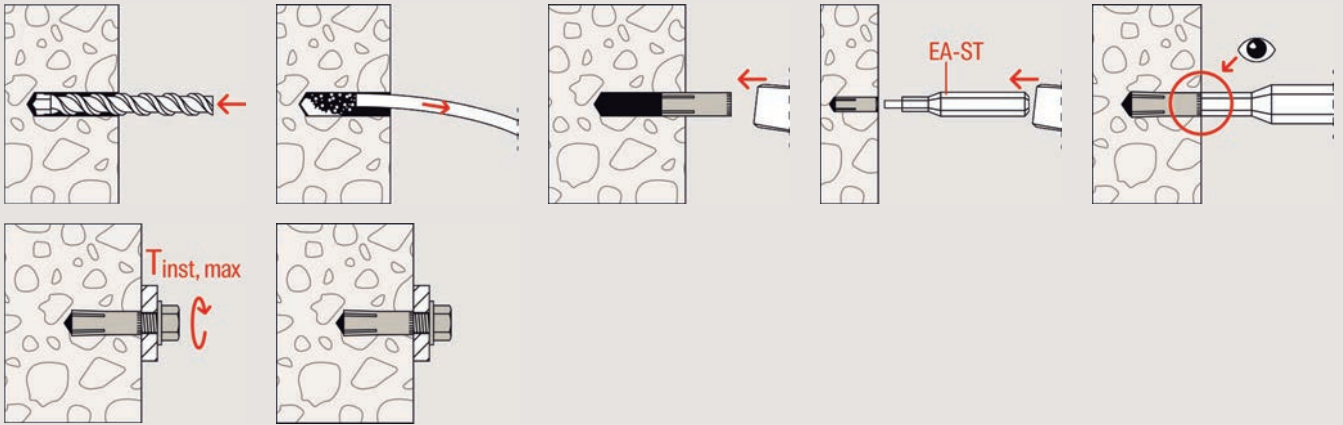

4

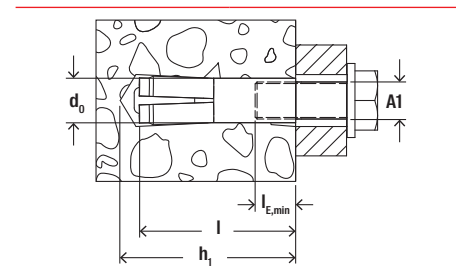

Technical data

Hammerset anchor EA N (metric)



EA-N Metric

Item	Item No.		Min. drill hole depth for pre-positioned installation h_1 [mm]	Anchor length l [mm]	Internal thread A1	Min. bolt penetration $l_{E,min}$ [mm]	Sales unit [pcs]
EA M 6 x 25 N gvz	535962	8	25	25	M 6	6	100
EA M 8 x 30 N gvz	535963	10	30	30	M 8	8	100
EA M10 x 40 N gvz	535964	12	40	40	M 10	10	50
EA M 12 x 50 N gvz	535965	15	50	50	M 12	12	50
EA M 16 x 65 N gvz	090163	20	65	65	M 16	16	25
EA M 20 x 80 N gvz	090164	25	80	80	M 20	20	25
EA M 12 x 50 N D gvz	500872	16	50	50	M 12	12	50

Technical data

EA N (imperial - metric)



EA-N Inch-metric

Item	Item No.	Drill hole diameter d_0 [mm]	Min. drill hole depth for pre-positioned installation h_1 [mm]	Anchor length l [mm]	Internal thread A1	Min. bolt penetration $l_{E,min}$ [mm]	Sales unit [pcs]
EA IM 1/4 x 25 N gvz	048103	8	25	25	1/4"	6	100
EA IM 5/16 x 30 N gvz	048104	10	30	30	5/16"	8	100
EA IM 3/8 x 40 N gvz	048105	12	40	40	3/8"	10	50
EA IM 1/2 x 50 N gvz	048106	16	50	50	1/2"	12	50
EA IM 5/8 x 65 N gvz	048107	20	65	65	5/8"	16	25
EA IM 3/4 x 80 N gvz	048108	25	80	70	3/4"	20	25

Technical data

Hammer set anchor EA N (imperial)



EA-N Inch

Item	Item No.	Drill diameter d_0 [inch]	Min. drill hole depth for pre-positioned installation h_1 [inch]	Total length l [inch]	Internal thread A1 [inch]	Min. bolt penetration $l_{E,min}$ [inch]	Sales unit [pcs]
EA I 1/4 x 1" N gvz	049185	3/8	1	1	1/4	1/4	100
EA I 5/16 x 13/16" N gvz	049194	3/8	1 1/4	1 1/4	5/16	5/16	100
EA I 3/8 x 19/16" N gvz	049195	1/2	1 9/16	1 5/8	3/8	3/8	50
EA I 1/2 x 2" N gvz	049197	5/8	2	2	1/2	1/2	50
EA I 5/8 x 2 1/2" N gvz	049198	3/4	2 3/8	2 1/2	5/8	5/8	20

Technical data

Setting tool EA-ST



EA-ST

Item	Item No.	Match	Sales unit [pcs]
EA-ST 6	504573	EA N M6	1
EA-ST 8	504576	EA N M8	1
EA-ST 10	504584	EA N M10	1
EA-ST 12	504585	EA N M12	1
EA-ST 16	504586	EA N M16	1
EA-ST 20	504587	EA N M20	1

Loads

Hammerset anchor EA-N

Recommended loads¹⁾ of a single anchor in normal concrete of strength class C20/25.

Type	Material/ surface ²⁾	Screw material	Effective anchorage depth h_{ef} [mm]	Minimum member thickness h_{min} [mm]	Maximum installation torque $T_{inst,max}$ [Nm]	Non-cracked concrete		
						Recommended tension load (N_{rec}); minimum spacing (s_{min}) and edge distances (c_{min}) with reduced loads	N_{rec} [kN]	$s_{min}^{2)}$ [mm]
EA M6 x 25 N ³⁾	gvz	≥ 4.6	25	100	4	2.0	65	115
EA M8 x 30 N ³⁾	gvz	≥ 4.6	30	100	8	2.5	95	140
EA M10 x 40 N	gvz	≥ 4.6	40	100	15	4.5	150	180
EA M12 x 50 N	gvz	≥ 4.6	50	120	35	6.0	145	200
EA M12 x 50 N D	gvz	≥ 4.6	50	120	35	6.0	145	200
EA M16 x 65 N	gvz	≥ 4.6	65	160	60	11.5	180	240
EA M20 x 80 N	gvz	≥ 4.6	80	200	120	16.0	190	280

¹⁾ Required safety factors are considered.

²⁾ Minimum possible axial spacings resp. edge distance while reducing the recommended load.

³⁾ Only suitable for statically indeterminate systems.