

DrillTech

SSW7-85 stainless steel insulation washer



Technical Data Sheet

Typical Applications

- Stainless steel washer for retaining soft insulation
- Centre fixing insulation back to steel frame (with DrillTech SSLSC screw)

Product Information

Material: stainless steel
Grade: A2 (304)
Finish: passivated

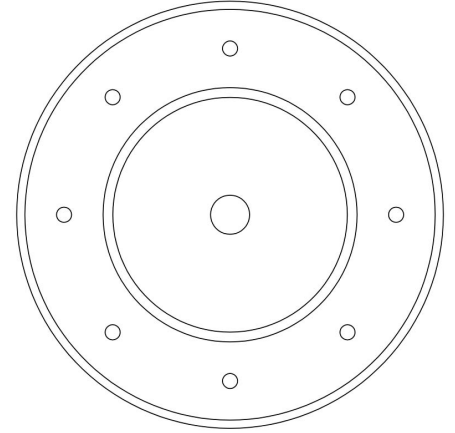

Dimensions

Outer Diameter	Hole Diameter	Material Thickness	Washer Weight
85 mm	7.0 mm	0.5 mm	22.8 g

Material Performance

Property	Result
tensile strength	515 - 1035 MPa
yield strength	205 MPa
elongation	40 %

All product specifications and data are subject to change without notice. The data contained in this datasheet is believed to be accurate and is reproduced in good faith. It is the customer's responsibility to ensure that the product described in this datasheet is suitable for their application.

VJ Technology disclaims any and all liability for any errors, inaccuracies or incompleteness contained in the datasheet. In addition VJ Technology makes no warranty, representation or guarantee regarding the suitability of the product described by the datasheet for any particular or associated purchase.